



12 Chauncey Circle • Ardsley, NY 10502

Welcome to CHAUNCEY ESTATES! Stunning new construction in Ardsley offering state of the art infrastructure & style! An idyllic NEWLY built cul-de-sac of 4 homes & over 5.5 acres of forever-green space. This is the 3rd of these exceptional homes, to be built, by renowned Greenwich Builders with an opportunity to customize. This distinctive 5 BR, 4.5 bath, Colonial sits on a 1.16 park-like acre in The Ardsley School District. Top quality construction and craftsmanship. Home has a wonderful open layout offering great space, light, generously proportioned rooms and 9 Ft ceilings on the 1st floor. Square footage does not include 1,800 Sq Ft in basement. Close to schools and shops. Desirable Greenburgh Rec and Hartsdale Train parking. TIME TO CUSTOMIZE AND BUILD YOUR DREAM HOME!

TRACY ISAACS *Licensed Real Estate Broker* | c: 914.462.1027 | o: 914.713.2072 | tracy.isaacs@juliabfee.com



Julia B
Fee

Sotheby's
INTERNATIONAL REALTY



CHAUNCEY ESTATES

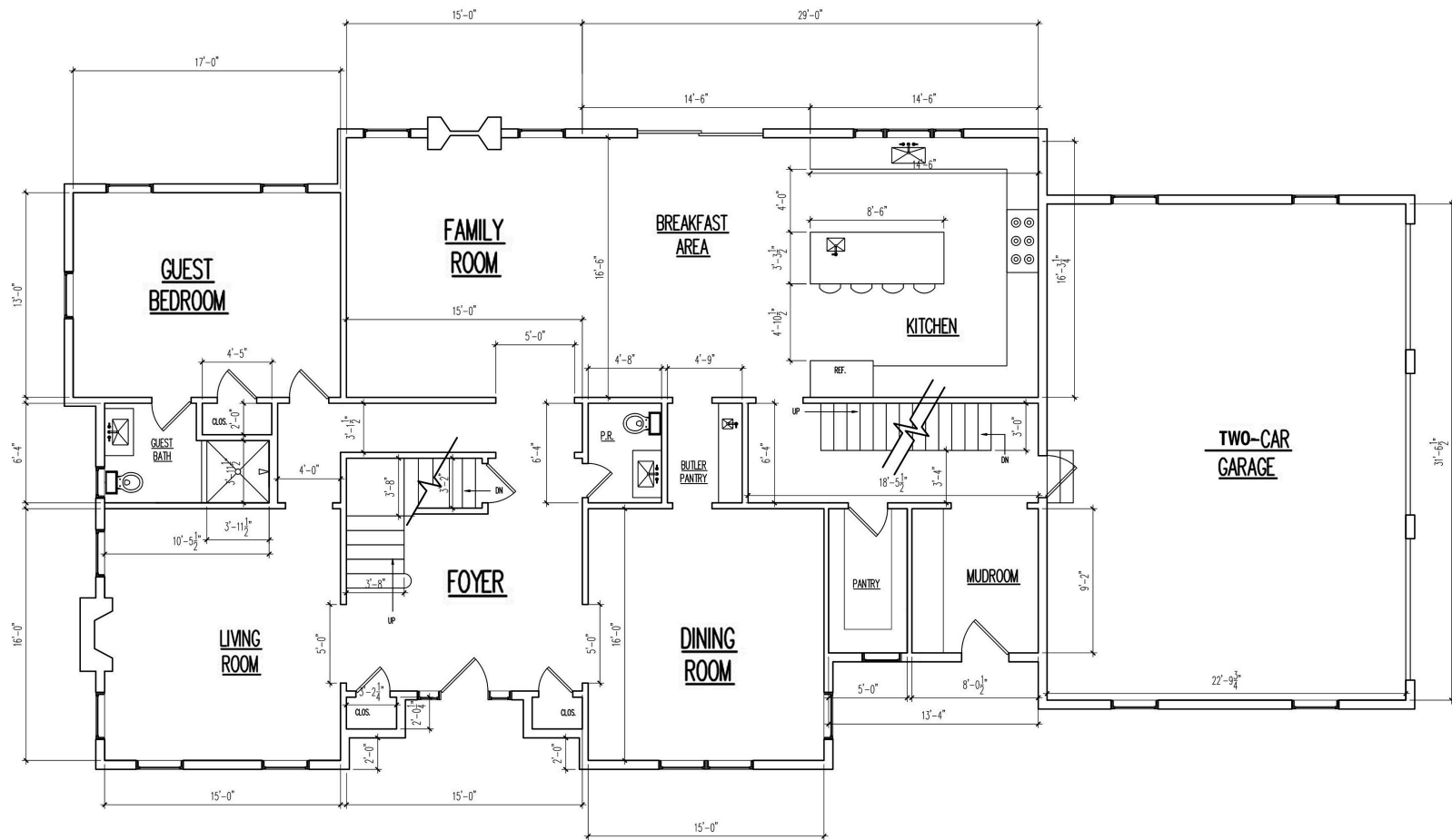

PROPOSED FIRST FLOOR PLAN
1/4" = 1'-0"

12 Chauncey Circle, Ardsley, NY

First Floor

CHAUNCEY ESTATES

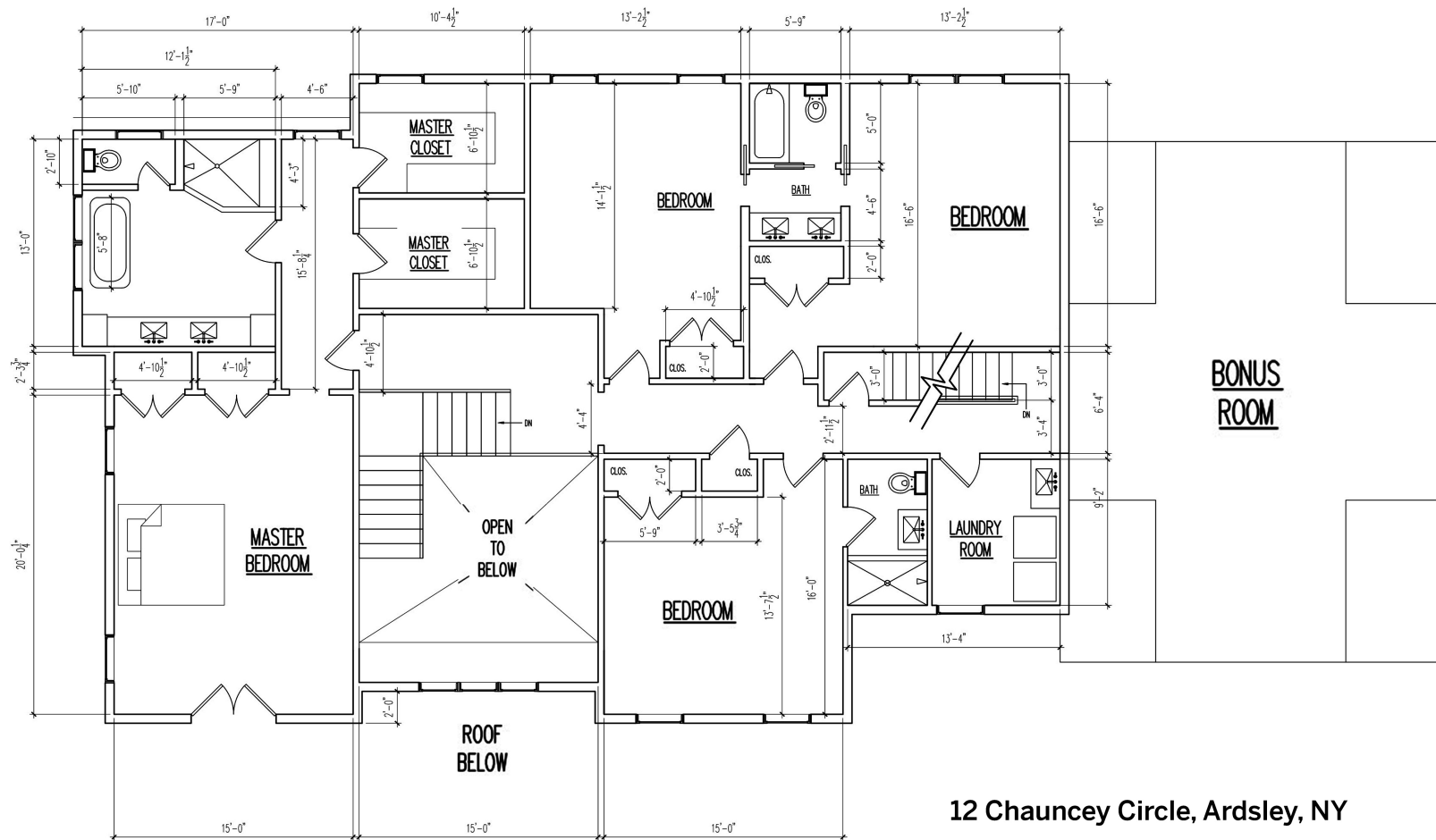

12 Chauncey Circle, Ardsley, NY

PROPOSED SECOND FLOOR PLAN
1/4" = 1'-0"

Second Floor

12 Chauncey Circle, Ardsley, NY



1 PROPOSED FRONT ELEVATION
1/4" = 1'-0"



2 PROPOSED REAR ELEVATION
1/4" = 1'-0"

Front and Back Elevations

12 Chauncey Circle, Ardsley, NY



PROPOSED SIDE ELEVATION
1/4" = 1'-0"



PROPOSED SIDE ELEVATION
1/4" = 1'-0"

Side Elevations

